

● **OUTDOOR WALL MOUNTING BRACKET SET**

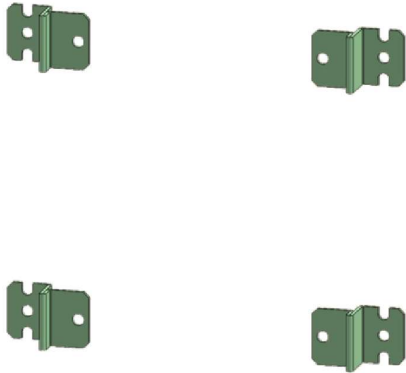

ORDER NO	TYPE	DESCRIPTION	THICKNESS	QTY
784 456	ODWMB	OUTDOOR WALL MOUNTING BRACKET SET	3.0mm	Set of 4 Nos

● **OUTDOOR POLE CLAMP SET**

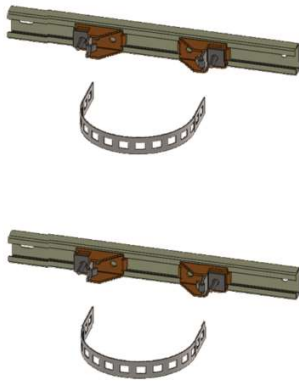

ORDER NO	TYPE	DESCRIPTION	DIMENSIONS (W) mm	THICKNESS	QTY
784 457	ODPMB 400	OUTDOOR POLE CLAMP SET	400	2.0mm	Set of 2 Nos
784 458	ODPMB 500	OUTDOOR POLE CLAMP SET	500	2.0mm	Set of 2 Nos
784 459	ODPMB 600	OUTDOOR POLE CLAMP SET	600	2.0mm	Set of 2 Nos

Wall/Pole Mounting Enclosure Includes, cabin , hinged door with locks, mounting plate, canopy.

Lock 1: IEC common key steel lock, Different key steel lock available as optional item

Lock 2: Die-casted knob lock (UV resistant) with common key with provision for padlock

Made of Electro-Galvanized steel (EG) & powder coated in RAL 7032 exterior powder

Optional materials : 1.Made of Hot Dipped Galvanized (HDG) steel sheet & powder coated in RAL 7032 exterior powder

2.Made of Electro-Galvanized steel (EG) & Hot dip Galvanized + marine paint finish

3. Made of Stainless Steel (SS) & powder coated in RAL 7032 exterior powder

Optional Colors: RAL 7035 exterior powder / Any other color as per request

UPDATE ON	REPLACE OF	05/12/2023
-----------	------------	------------